

SIZE SELECTION GUIDE				
SIZE	RATED FLOW (CFM)	DIM. "A" (IN.)	DIM. "B" (IN.)	WEIGHT (LBS)
1/2 X 1	900	18	27	85
1 X 1	2000	30	27	115
1 X 2	4000	30	51	175
2 X 1	4000	60	27	230

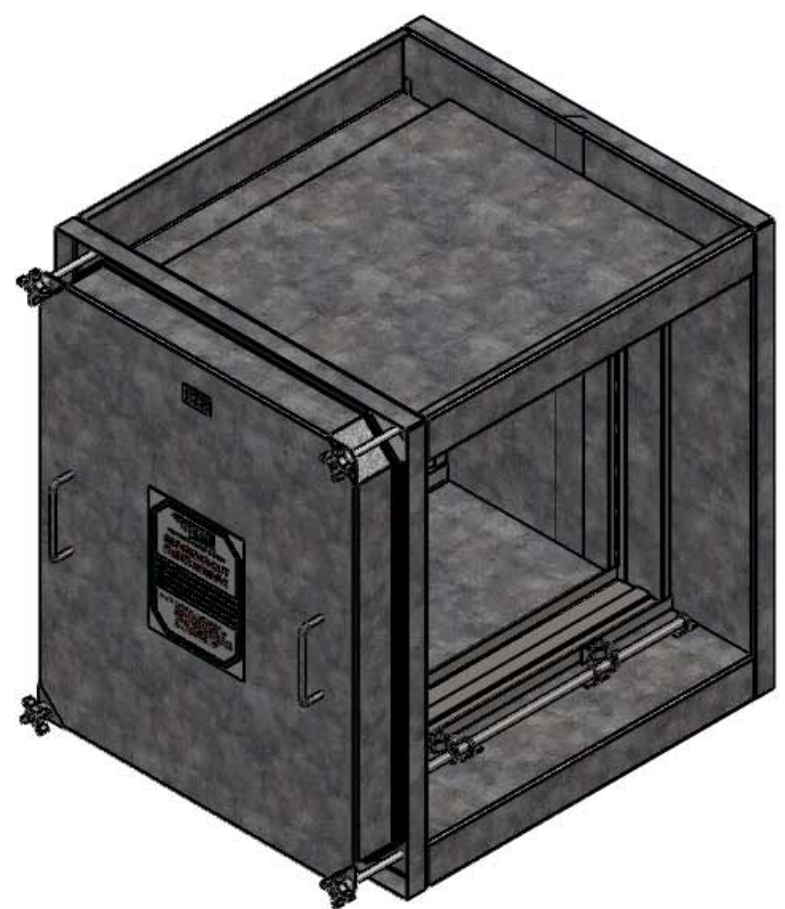
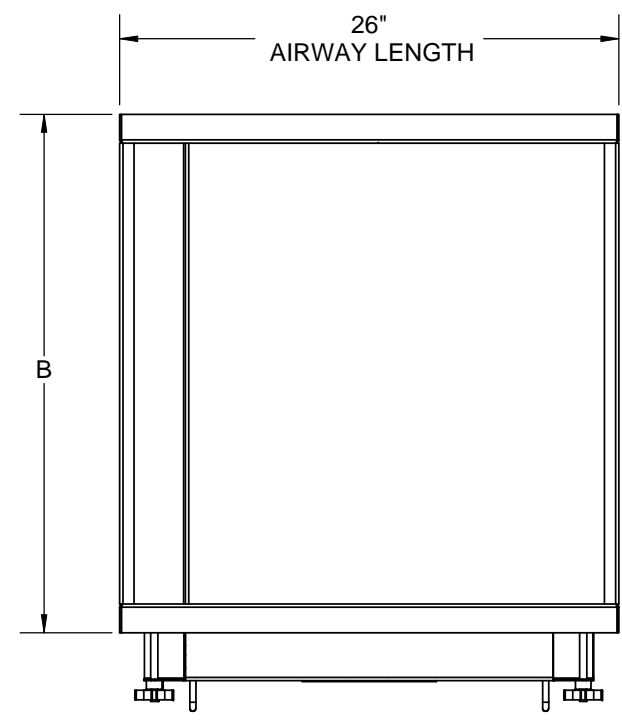

GENERAL NOTES & SYSTEM INFORMATION

1. FILTER HOUSING IS CONSTRUCTED OF 14 GA. GALVANIZED STEEL. ALL JOINTS AND SEAMS, WITH THE EXCEPTION OF THE BAGGING RING, ARE FULLY WELDED.
2. ALL WELDS ARE REMOVED OF OXIDATION AND PRIMED/PAINTED WITH COLD GALVANIZE COMPOUND.
3. UNIT IS PRESSURE DECAY TESTED TO +/- 5" W.G. ON THE SEAL SURFACE AND THE OVERALL PRESSURE BOUNDARY.
4. MINIMUM OF FOUR (4) FEET OF CLEARANCE IN FRONT OF ACCESS DOOR IS RECOMMENDED FOR FILTER REMOVAL.
5. MATERIAL OF CONSTRUCTION: 14 GA. GALVANIZED STEEL WITH ALL STAINLESS STEEL LOCKING MECHANISM AND PREFILTER TRACK
6. ONE (1) ACCESS DOOR FOR HEPA AND PREFILTER.
7. UNIQUE LOCKING MECHANISM ALLOWS ONE-HANDED OPERATION TO APPLY UP TO 1400 LBS. SEALING FORCE FOR GASKET-SEAL FILTER.

WEATHER DRAIN SLOTS LOCATED AT ALL CORNERS

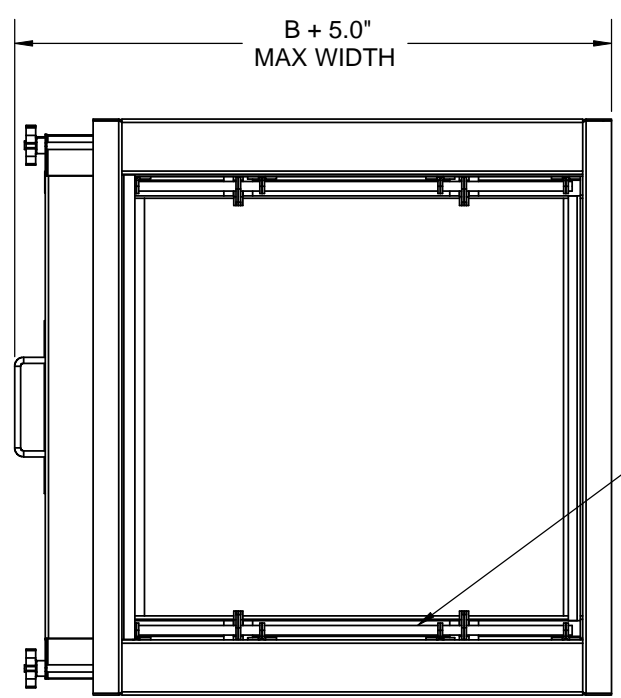
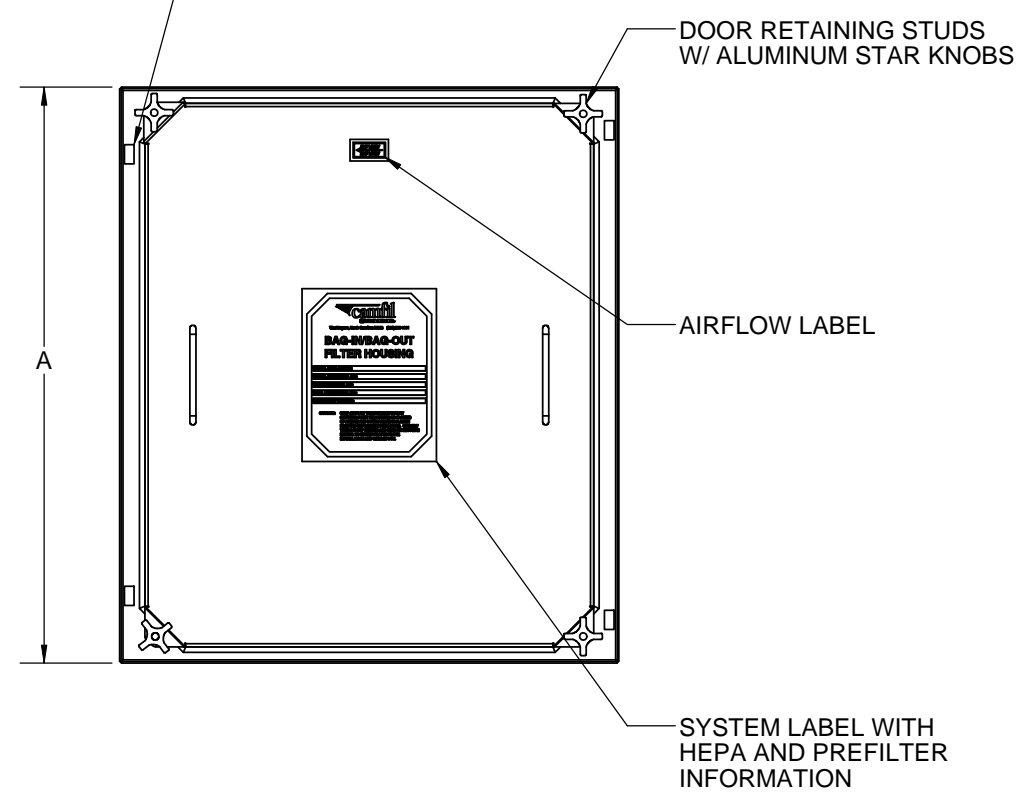

HEPA FILTER

HOUSING ACCOMMODATES A 12" NOMINAL DEPTH FILTER

PRE-FILTER

HOUSING ACCOMMODATES A 4" NOMINAL DEPTH PREFILTER

*PRE-FILTER CAN BE REMOVED WITHOUT DISTURBING HEPA FILTER SEAL

ALL STAINLESS STEEL LOCKING MECHANISM WITH INTEGRATED PREFILTER TRACK

UNLESS OTHERWISE SPECIFIED TOLERANCES ARE:	
ANGULAR:	+/-1
FRACTION:	+/-1/16"
DECIMAL:	+/-0.0625"
DRAWN BY:	DATE:
KGW	8/26/10
CHECK BY:	DATE:
JDN	8/26/10
APPR. BY:	DATE:
RBD	8/26/10

camfil WASHINGTON NORTH CAROLINA www.camfilarr.com

DRAWING TITLE:
CAMHOSP ISO HOUSING CONFIGURATIONS

REV.	DRAWN BY DATE	DESCRIPTION:	CHECK BY DATE	APPR. BY DATE	SCALE: 1:10	DWG SIZE: B	DRAWING NO.: M60002907	SHEET: 1	OF: 1	REV.: 0
------	---------------	--------------	---------------	---------------	-------------	-------------	------------------------	----------	-------	---------